

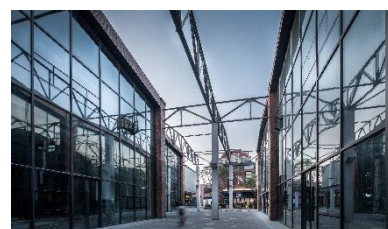

TIANTUO LIVABLE COMMUNITY

Client	Tianjin Municipal Bureau of Planning and Natural Resources
Services	Urban Design / Architecture Design / Urban Regeneration / Livable City
Location	Tianjin
Scale	98 HA
Collaborator	TADI / Kragh & Berglund Landscape
Time	2012
Status	Completed

As an old industrial base in Tianjin, the Tractor Factory of Tianjin made outstanding contributions to the industrial development of China in 1950s. As time develops, its industrial function is no longer prominent. Through this renovation, we aim to achieve its transformation of functions and make this project a successful practice of industrial heritage conservation in Tianjin. From spatial structure, landscape, industrial relics, signage, chimneys, rail tracks, tubes/pipes to each building, we provide detail design to protect buildings with local characteristics and five main factories. Two main green axis connect all preserved buildings with the city, parks and communities.

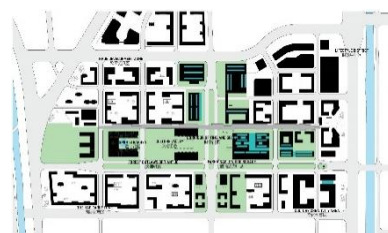



Project Master Plan

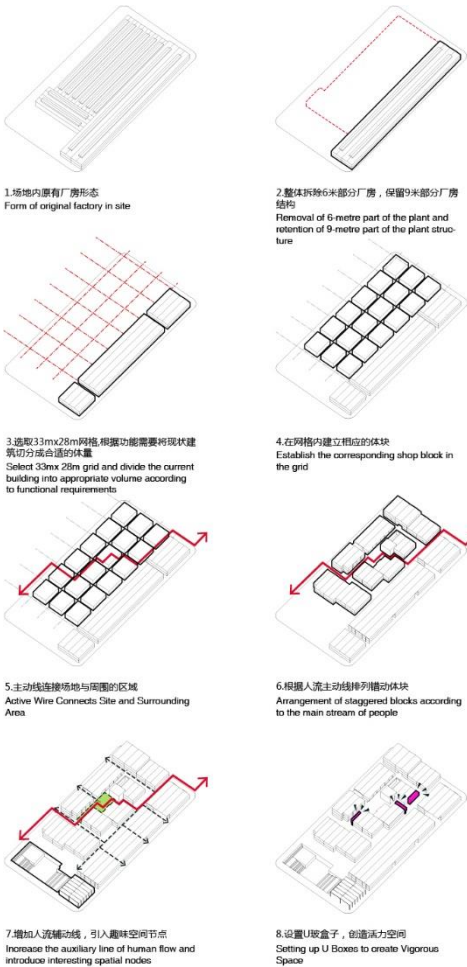

System Diagram



Before restoration



After Restoration





Street View 复合型街区

