

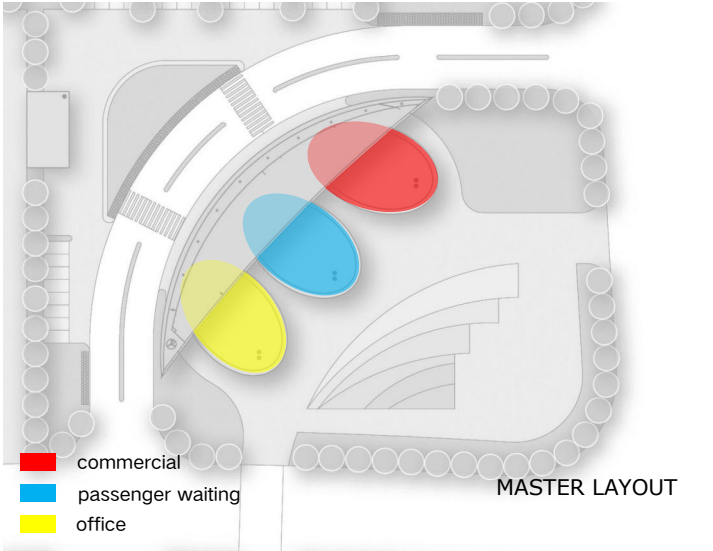

ZHONGBEI BUS STATION

Type	Service Facilities
Services	Architecture Design
Location	Zhongbei Town, Xiqing District, Tianjin
Client	Zhongbei Government
Scale	2096sqm
Time	2009

With the rapid urbanization of this area, many residential and industrial facilities has been built. It is urgent to establish public transportation system. Zhongbei Bus Station will become an urban traffic hub not only provides high-quality traffic system to this area, but also shows the city image. The architecture consists of three "egg-shaped" buildings covered by a 100-meter-long light canopy, which is fresh and elegant. The facade is double-skin structure, with normal windows and wall on the inside, white aluminum grille on the outside, making the building not only a bus station, but also a new city landmark.

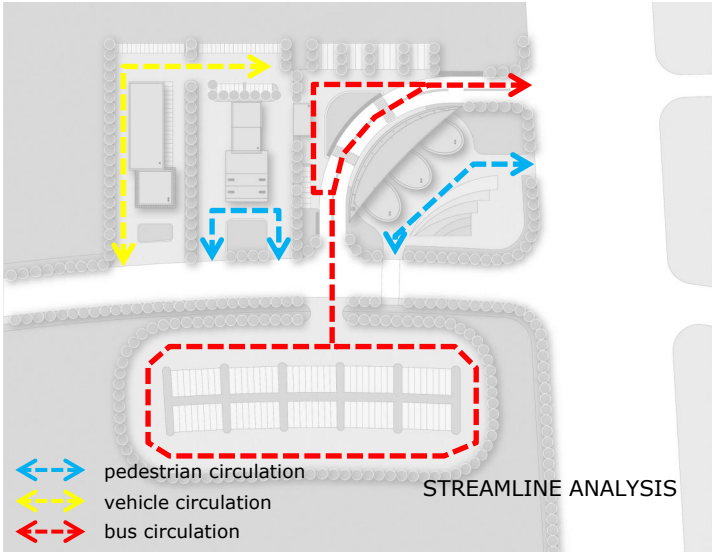
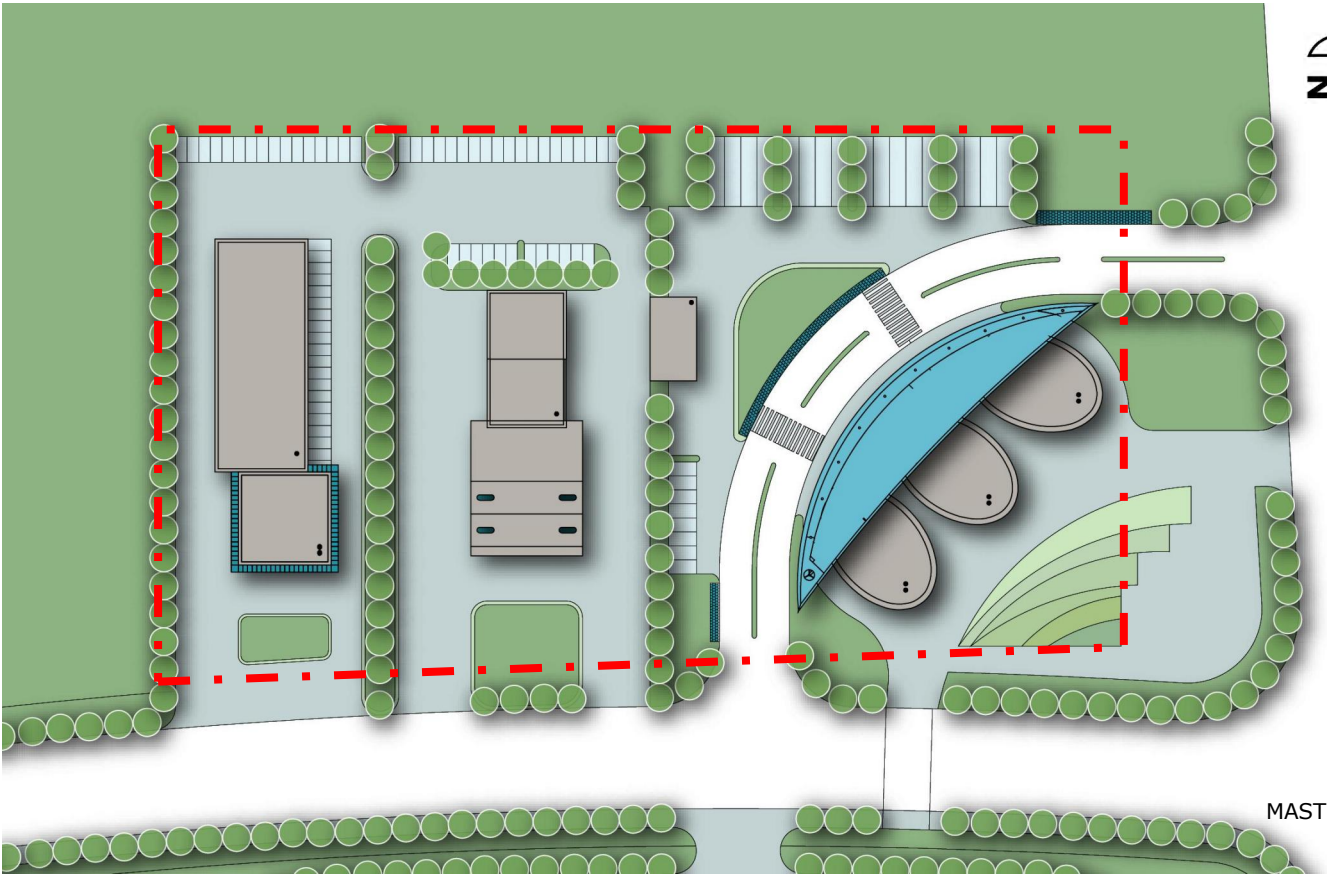





BUILDING FAÇADE